



Marcegaglia stands out today as the world's top producer of stainless steel welded tubes with top-level certified manufacturing activities worldwide and an overall capacity of 400 thousand tons per year.

Marcegaglia è oggi il maggior produttore mondiale di tubi saldati in acciaio inossidabile, con stabilimenti in tutto il mondo all'avanguardia per tecnologia e certificazioni ed una capacità produttiva annua totale di 400 mila tonnellate.

Stainless steel welded tubes

Tubi saldati in acciaio inossidabile

 MARCEGAGLIA

Marcegaglia process pipe range include certified products for applications in the food and dairy industry, drinkable water, chemical and pharmaceutical, oil and gas, heat exchangers, electrical resistances and other mechanical applications.

La gamma di prodotti certificati per applicazioni nel trasporto dei fluidi include tubi per il settore alimentare e lattiero-caseario, per acque potabili e per il settore chimico e farmaceutico, oltre a tubi per impieghi nel settore petrolchimico, nel settore degli scambiatori di calore e delle resistenze elettriche e per altre applicazioni meccaniche.

Typical applications

Esempi delle principali applicazioni

Process pipes for fluids

Tubi per il trasporto di fluidi







Typical applications

Esempi delle principali applicazioni

Construction and ornamental tubes

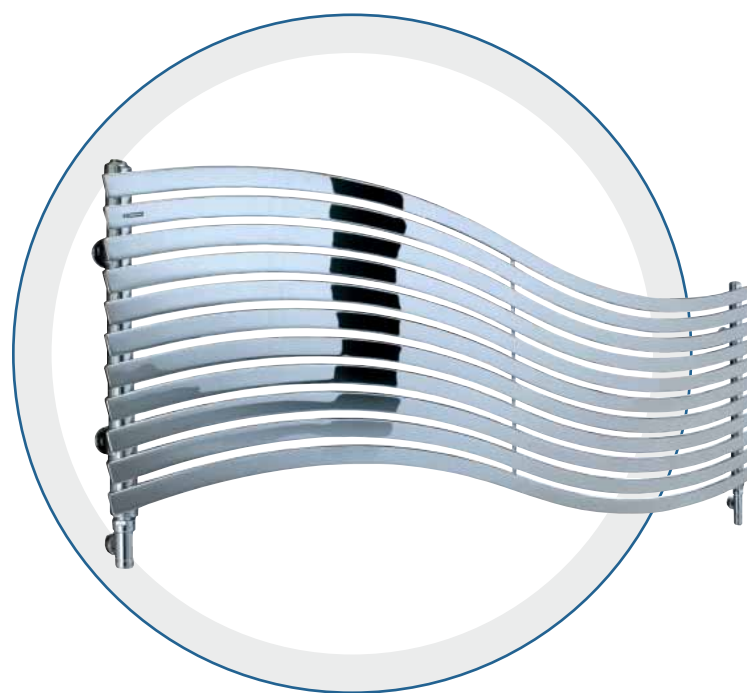
Tubi per costruzione e decorazione





**Building with steel means excellence.
Mechanical properties, aesthetic values
and durability: stainless steel
is the environment-friendly material
of choice for contemporary architecture.**

*Costruire in acciaio significa scegliere l'eccellenza.
Proprietà meccaniche ed estetiche,
durata nel tempo, rispetto per l'ambiente
sono i valori chiave che fanno dell'acciaio inossidabile
la materia prima ideale per l'architettura.*

Typical applications

Esempi delle principali applicazioni

Tubes for mechanical and automotive applications

Tubi per applicazioni meccaniche e automotive

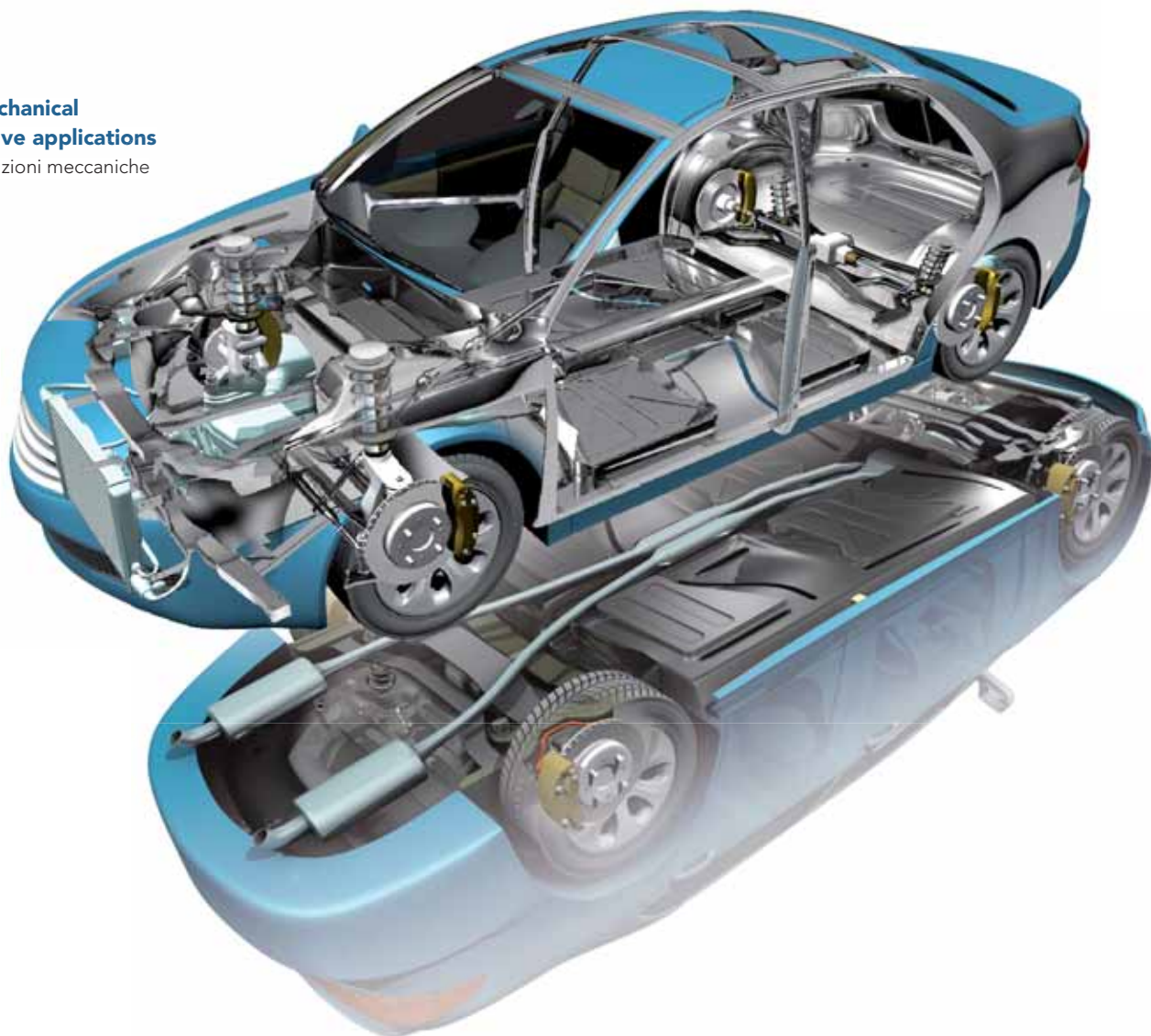

The product range of tubes for exhaust systems, tubes for hydroforming applications and special shapes for automotive construction is engineered and manufactured in Marcegaglia stainless steel production plants worldwide: Brazil, USA, Russia, China and Italy, hosting more than 70 high-technology tube processing lines.

La gamma di tubi per sistemi di scarico, tubi per idroformatura e sagome speciali per applicazioni automotive è sviluppata e prodotta negli stabilimenti Marcegaglia in Brasile, Stati Uniti, Russia, Cina e Italia che ospitano più di 70 linee per la formatura e saldatura di tubi in acciaio inossidabile austenitico e ferritico.



United States

Russia

China

Italy

Brazil

Stainless steel welded tubes

Tubi saldati in acciaio inossidabile

Main manufacturing standards

Principali norme di produzione

	MANUFACTURING STANDARD <i>Norma di fabbricazione</i>	PRODUCT DESIGNATION <i>Designazione prodotto</i>	GRADE EN <i>Qualità EN</i>	GRADE AISI <i>Qualità AISI</i>
PROCESS PIPES FOR FLUIDS <i>TRASPORTO FLUIDI</i>	EN 10217-7 (A 270) (DIN 11850)	Process pipes for the food and dairy industry <i>Tubi per trasporto fluidi, settore alimentare e caseario</i>	1.4301 1.4307 1.4404	304 304L 316L
	EN 10217-7 (DVGW GW541)	Process pipes for drinkable water and press fitting <i>Tubi per trasporto fluidi, settore acque potabili e press fitting</i>	1.4404 1.4521	316L 444
	EN 10217-7 EN 10312	Process pipes for water treatment <i>Tubi per trasporto fluidi, settore trattamento acque</i>	1.4301 1.4307 1.4404 1.4541 1.4571	304 304L 316L 321 316Ti
	EN 10217-7	Process pipes for the pulp and paper sector <i>Tubi per trasporto fluidi, settore cartario</i>	1.4301 1.4307 1.4404 1.4541 1.4571	304 304L 316L 321 316Ti
	EN 10217-7 (AD 2000 W2/W10) (PED 97/23)	Process pipes for chemical applications <i>Tubi per trasporto fluidi, settore chimico</i>	1.4301 1.4307 1.4404 1.4541 1.4571	304 304L 316L 321 316Ti
	EN 10217-7 (DIN 11866)	Process pipes for pharmaceutical applications <i>Tubi per trasporto fluidi, settore farmaceutico</i>	1.4404	316L
	EN 10217-7 (A 312 / A 778)	Process pipes for oil and gas applications <i>Tubi per trasporto fluidi, settore petrolchimico</i>	14307 14404	304L 316L



	MANUFACTURING STANDARD <i>Norma di fabbricazione</i>	PRODUCT DESIGNATION <i>Designazione prodotto</i>	GRADE EN <i>Qualità EN</i>	GRADE AISI <i>Qualità AISI</i>	
MECHANICAL APPLICATIONS <i>APPLICAZIONI MECCANICHE</i>	EN 10296 EN 10217-7	Round tubes for pumps and cylinders <i>Tubi per applicazioni meccaniche, pompe e cilindri</i>	1.4301 1.4307 1.4404 1.4541 1.4571	304 304L 316L 321 316Ti	
	EN 10217-7	Round tubes for elbows and fittings <i>Tubi per applicazioni meccaniche, raccordi e curve</i>	1.4301 1.4307 1.4404 1.4541 1.4571	304 304L 316L 321 316Ti	
	EN 10217-7	Round tubes for heat resistances <i>Tubi per applicazioni meccaniche, resistenze elettriche</i>	1.4301 1.4307 1.4404 1.4541 1.4571 1.4876 2.4858	304 304L 316L 321 316Ti Incoloy 800 Incoloy 825	
	HEAT TREATMENT <i>SCAMBIO TERMICO</i>	EN 10217-7 (A 249) (AD 2000 W2/W10) (PED 97/23)	Round tubes for heat exchangers <i>Tubi per scambiatori di calore</i>	1.4301 1.4307 1.4404 1.4541 1.4571	304 304L 316L 321 316Ti
		EN 10296 EN 10217-7	Round tubes for evaporators for the sugar industry <i>Tubi per scambio termico, settore zuccherifici</i>	1.4301 1.4307 1.4404 1.4541 1.4571 1.4509 1.4510	304 304L 316L 321 316Ti 441 439
		EN 10217-7 (AD 2000 W2/W10)	Round tubes for pressure vessels <i>Tubi per recipienti a pressione</i>	1.4301 1.4307 1.4404 1.45241 1.4571	304 304L 316L 321 316Ti
		EN 10217-7	Tubes for boilers <i>Tubi per serpentine per caldaie</i>	1.4301 1.4307 1.4404 1.4541 1.4571	304 304L 316L 321 316Ti

Main manufacturing standards

Principali norme di produzione

	MANUFACTURING STANDARD <i>Norma di fabbricazione</i>	PRODUCT DESIGNATION <i>Designazione prodotto</i>	GRADE EN <i>Qualità EN</i>	GRADE AISI <i>Qualità AISI</i>
CONSTRUCTION <i>STRUTTURALI</i>	EN 10296 (A 554)	Construction round tubes and box sections <i>Tubi tondi e sagomati per impieghi strutturali</i>	1.4301	304
			1.4307	304L
			1.4404	316L
			1.4541	321
			1.4571	316Ti
			1.4509	441
ORNAMENTAL <i>DECORAZIONE</i>	EN 10296 (A 554)	Ornamental round tubes and box sections <i>Tubi tondi e sagomati per decorazione</i>	1.4301	304
			1.4307	304L
			1.4404	316L
			1.4541	321
			1.4571	316Ti
			1.4509	441
AUTOMOTIVE	EN 10296 (A 554)	Round tubes for automotive, exhaust systems <i>Tubi tondi per impieghi automotive, sistemi di scarico</i>	1.4301	304
			1.4307	304L
			1.4512	409
			1.4509	441
			1.4510	439
			EN 10296 (A 554)	Round tubes for automotive, hydroforming appliance <i>Tubi tondi per impieghi automotive, idroformatura</i>
	1.4307	304L		
	1.4404	316L		
	1.4541	321		
	1.4571	316Ti		
	1.4512	409		
	EN 10296 (A 554)	Round tubes and box sections for automotive frame construction <i>Tubi tondi e sagome speciali per impieghi automotive, telai</i>	1.4301	304
1.4307			304L	

Supply conditions - *Condizioni di fornitura*

- Dimensional tolerances according to manufacturing standard

Tolleranze dimensionali secondo le norme di fabbricazione

- Special tolerances upon request *Tolleranze speciali su richiesta*

- Control documents 2.2, 3.1, 3.2 according to EN 10204 and specific norm requirements

Documenti di controllo 2.2, 3.1, 3.2 secondo norma EN 10204 e indicazioni specifiche di ciascuna norma

Main steel grades

Principali acciai impiegati

METAL STRUCTURE <i>Struttura</i>	GRADE <i>Qualità</i>		TYPICAL CHEMICAL COMPOSITION <i>Composizione chimica indicativa</i>												
	EN	AISI	C	Ni	Cr	Mo	Ti	Nb	Mn	Si	P	S	N	Cu	Others
Austenitic	1.4301	304	≤ 0,07	8,00-10,50	17,00-19,50	-	-	-	≤ 2,00	≤ 1,00	≤ 0,045	≤ 0,015	≤ 0,10	-	-
Austenitic	1.4307	304L	≤ 0,03	8,00-10,00	17,50-19,50	-	-	-	≤ 2,00	≤ 1,00	≤ 0,045	≤ 0,015	≤ 0,10	-	-
Austenitic	1.4541	321	≤ 0,08	9,00-12,00	17,00-19,00	-	5xC-0,70	-	≤ 2,00	≤ 1,00	≤ 0,045	≤ 0,015	-	-	-
Austenitic	1.4404	316L	≤ 0,03	10,00-13,00	16,50-18,50	2,00-2,50	-	-	≤ 2,00	≤ 1,00	≤ 0,045	≤ 0,015	≤ 0,10	-	-
Austenitic	1.4571	316Ti	≤ 0,08	10,50-13,50	16,50-18,50	2,00-2,50	5xC-0,70	-	≤ 2,00	≤ 1,00	≤ 0,045	≤ 0,015	-	-	-
Austenitic	1.4828	309S	≤ 0,20	11,00-13,00	19,00-21,00	-	-	-	≤ 2,00	1,50-2,50	≤ 0,045	≤ 0,030	-	-	-
Austenitic	1.4371	201LN	≤ 0,030	3,50-5,50	16,00-17,00	-	-	-	6,00-8,00	≤ 1,00	≤ 0,045	≤ 0,015	0,15-0,20	-	-
Ni Alloy	2.4816	Inconel 600	≤ 0,15	≥ 72,00	14,70-17,00	-	-	-	≤ 1,00	≤ 0,50	-	≤ 0,015	-	≤ 0,50	-
Ni Alloy	2.4851	Inconel 601	≤ 0,10	58,00-63,00	21,00-25,00	-	-	-	≤ 1,00	≤ 0,50	-	≤ 0,015	-	≤ 1,00	-
Super Austenitic	1.4876	Incoloy 800	≤ 0,10	30,00-35,00	19,00-23,00	-	0,15-0,60	-	≤ 1,50	≤ 1,00	-	≤ 0,015	-	≤ 0,75	Al 0,15-0,60
Ni Alloy	2.4858	Incoloy 825	≤ 0,05	38,00-46,00	19,50-23,50	2,50-3,50	0,60-1,20	-	≤ 1,00	≤ 0,50	-	≤ 0,030	-	1,50-3,00	Al ≤ 0,20
Ferritic	1.4512	409	≤ 0,03	-	10,50-12,50	-	-	-	≤ 1,00	≤ 1,00	≤ 0,040	≤ 0,015	-	-	-
Ferritic	1.4526	436	≤ 0,080	-	16,00-18,00	0,80-1,40	-	[7X(C+N)+0,10]-1,00	≤ 1,00	≤ 1,00	≤ 0,040	≤ 0,015	≤ 0,040	-	-
Ferritic	1.4510	439	≤ 0,050	-	16,00-18,00	-	[4x(C+N)+0,15]-0,80	-	≤ 1,00	≤ 1,00	≤ 0,040	≤ 0,015	-	-	-
Ferritic	1.4509	441	≤ 0,03	-	17,50-18,50	-	0,10-0,60	[3xC+0,30]-1,00	≤ 1,00	≤ 1,00	≤ 0,040	≤ 0,015	-	-	-
Ferritic	1.4521	444	≤ 0,025	-	17,00-20,00	1,80-2,50	[4x(C+N)+0,15]-0,80	-	≤ 1,00	≤ 1,00	≤ 0,040	≤ 0,015	≤ 0,030	-	-
Duplex	1.2101	ATI 2003	≤ 0,030	3,00-4,00	19,50-22,50	1,50-2,00	-	-	≤ 2,00	≤ 1,00	≤ 0,030	≤ 0,020	0,14-0,20	-	-

STANDARD AND OPTIONAL TESTING

Prove e controlli standard e opzionali

Chemical composition - *Analisi chimica*

Micrographic analysis - *Analisi micrografica*

Tensile test at room temperature or other temperature

Prova di trazione a temperatura ambiente e a temperatura diversa da quella ambiente

Flattening test - *Prova di schiacciamento*

Expansion test - *Prova di allargamento*

Radial expansion test - *Prova di espansione radiale*

Bending test - *Prova di curvabilità*

Electromagnetic test - *Prova elettromagnetica di tenuta*

Non destructive eddy current weld test

Controllo non distruttivo sulla saldatura a correnti indotte

Dimensional test - *Controllo dimensionale*

Visual test - *Controllo visivo*

Surface roughness measurement - *Misurazione della rugosità*

Salt spray test

Prova di corrosione in nebbia salina

Test for corrosive traces - *Prova ai residui corrosivi*

Intergranular corrosion test - *Prova di corrosione intergranulare*

Potentiostatic corrosion test

Prove potenziostatiche di corrosione

Grain size measurement

Determinazione della dimensione del grano

Ferrite measurement

Controllo della percentuale di ferrite

Rupture test - *Prova di scoppio*

Release of special certificates - *Emissione di certificati speciali*

OPTIONAL PROCESSING

Lavorazioni opzionali

Heat treatments - *Trattamenti termici*

Pickling - *Decapaggio*

Outer surface brushing - *Spazzolatura esterna*

Inner and outer surface polishing - *Satinatura esterna e interna*

Inner and outer surface mirror polishing

Lucidatura a specchio esterna e interna

Tubes individually sleeved - *Inguainatura del singolo tubo*

Bead rolling or weld seam removing - *Laminazione/Scordonatura interna*

Cut to length - *Taglio a misura*

Customer defined marking - *Marcature alternative*

Customer defined tolerances - *Tolleranze su specifiche cliente*

Welding position (box sections)

Posizione della saldatura (tubo sagomato)

Special packaging - *Imballo specifico*

Round stainless steel welded tubes

Tubi tondi saldati in acciaio inossidabile

outside diameter mm	wall thickness mm													weight kg/m	
	0,80	1	1,2	1,5	1,6	2	2,5	2,6	3	3,2	3,6	4	5		6
6		0,125													
8	0,144	0,175													
10	0,184	0,225	0,264	0,319											
12	0,224	0,275	0,325	0,394	0,417	0,501									
12,7	0,238	0,293	0,346	0,421	0,445										
14	0,264	0,326	0,385	0,470	0,497	0,601									
15	0,284	0,351	0,415	0,507	0,537	0,651									
16	0,304	0,376	0,445	0,545	0,577	0,701									
17,2	0,329	0,406	0,481	0,590	0,625	0,761	0,920	0,951	1,067						
18	0,345	0,426	0,505	0,620	0,657	0,801	0,970	1,003	1,127						
19	0,365	0,451	0,535	0,657	0,697	0,851	1,033	1,068	1,202						
19,05	0,366	0,452	0,536	0,659	0,699	0,854	1,036	1,071	1,206						
20	0,385	0,476	0,565	0,695	0,737	0,901	1,096	1,133	1,277						
21,3	0,411	0,508	0,604	0,744	0,789	0,967	1,177	1,217	1,375						
22	0,425	0,526	0,625	0,770	0,817	1,002	1,221	1,263	1,427						
23	0,445	0,551	0,655	0,808	0,857	1,052	1,283	1,328	1,502						
24	0,465	0,576	0,685	0,845	0,897	1,102	1,346	1,393	1,578						
25	0,485	0,601	0,715	0,883	0,937	1,152	1,409	1,458	1,653						
25,4	0,493	0,611	0,727	0,898	0,954	1,172	1,434	1,484	1,683						
26,9	0,523	0,649	0,772	0,954	1,014	1,247	1,527	1,582	1,795						
28	0,545	0,676	0,805	0,995	1,058	1,302	1,596	1,654	1,878						
29	0,565	0,701	0,835	1,033	1,098	1,352	1,659	1,719	1,953						
30	0,585	0,726	0,865	1,070	1,138	1,402	1,722	1,784	2,028						
31,80	0,621	0,771	0,919	1,138	1,210	1,492	1,834	1,901	2,163						
32	0,625	0,776	0,925	1,146	1,218	1,502	1,847	1,914	2,178						
33	0,645	0,801	0,956	1,183	1,258	1,552	1,909	1,979	2,254						
33,7	0,659	0,819	0,977	1,209	1,286	1,588	1,953	2,025	2,306	2,444					
34	0,665	0,826	0,986	1,221	1,298	1,603	1,972	2,044	2,329	2,468					
35	0,685	0,851	1,016	1,258	1,338	1,653	2,035	2,109	2,404	2,548					
38	0,745	0,926	1,106	1,371	1,458	1,803	2,222	2,305	2,629	2,788	3,101	3,405			
40	0,785	0,977	1,166	1,446	1,538	1,903	2,348	2,435	2,779	2,949	3,281	3,606			
41		1,002	1,196	1,484	1,579	1,953	2,410	2,500	2,855	3,029	3,371	3,706			
42		1,027	1,226	1,521	1,619	2,003	2,473	2,565	2,930	3,109	3,462	3,806			
42,4		1,037	1,238	1,536	1,635	2,023	2,498	2,591	2,960	3,141	3,498	3,846			
43		1,052	1,256	1,559	1,659	2,053	2,535	2,630	3,005	3,189	3,552	3,906			
44,5		1,089	1,301	1,615	1,719	2,128	2,629	2,728	3,117	3,309	3,687	4,056			
45		1,102	1,316	1,634	1,739	2,153	2,661	2,760	3,155	3,349	3,732	4,107			
48		1,177	1,406	1,747	1,859	2,304	2,848	2,956	3,380	3,590	4,002	4,407			
48,3		1,184	1,415	1,758	1,871	2,319	2,867	2,975	3,403	3,614	4,029	4,437			
50		1,227	1,466	1,822	1,939	2,404	2,974	3,086	3,531	3,750	4,183	4,607			
50,8		1,247	1,490	1,852	1,971	2,444	3,024	3,138	3,591	3,814	4,255	4,687			
51		1,252	1,496	1,859	1,979	2,454	3,036	3,151	3,606	3,830	4,273	4,708			
52		1,277	1,526	1,897	2,019	2,504	3,099	3,216	3,681	3,910	4,363	4,808			
53		1,302	1,556	1,934	2,059	2,554	3,161	3,281	3,756	3,990	4,453	4,908			
54		1,327	1,587	1,972	2,099	2,604	3,224	3,346	3,831	4,071	4,543	5,008			
55		1,352	1,617	2,009	2,139	2,654	3,287	3,411	3,906	4,151	4,633	5,108			
57		1,402	1,677	2,085	2,220	2,754	3,412	3,542	4,056	4,311	4,814	5,308			
60,3		1,485	1,776	2,209	2,352	2,920	3,618	3,757	4,304	4,575	5,111	5,639	6,924		
63,5		1,565	1,872	2,329	2,480	3,080	3,819	3,965	4,545	4,832	5,400	5,960	7,324		
70		1,728	2,067	2,573	2,740	3,405	4,226	4,388	5,033	5,353	5,986	6,611	8,138		
73		1,803	2,157	2,686	2,861	3,556	4,413	4,583	5,258	5,593	6,256	6,911	8,514		
76,1		1,881	2,251	2,802	2,985	3,711	4,607	4,785	5,491	5,841	6,535	7,222	8,902		
80		1,978	2,368	2,948	3,141	3,906	4,852	5,039	5,784	6,154	6,887	7,612	9,390		
83		2,053	2,458	3,061	3,261	4,056	5,039	5,234	6,010	6,394	7,157	7,913	9,766		
84		2,078	2,488	3,099	3,301	4,107	5,102	5,299	6,085	6,474	7,248	8,013	9,891		
85		2,103	2,518	3,136	3,341	4,157	5,165	5,365	6,160	6,554	7,338	8,113	10,016		
88,9			2,635	3,283	3,498	4,352	5,409	5,618	6,453	6,867	7,689	8,504	10,504		
95				3,512	3,742	4,657	5,791	6,016	6,911	7,356	8,239	9,115	11,268		
101,6				3,760	4,006	4,988	6,204	6,445	7,407	7,885	8,834	9,776	12,094		
103				3,812	4,062	5,058	6,291	6,536	7,512	7,997	8,960	9,916	12,270		
104				3,850	4,103	5,108	6,354	6,602	7,587	8,077	9,050	10,016	12,395		
108				4,000	4,263	5,308	6,604	6,862	7,888	8,397	9,411	10,417	12,896		
114,3				4,237	4,515	5,624	6,999	7,272	8,361	8,902	9,979	11,048	13,684	16,271	

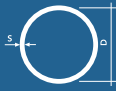

ROUND TUBES EN 10217-7, EN 10296

Tubi tondi EN 10217-7, EN 10296

weight
kg/m

outside diameter mm	wall thickness mm													
	0,80	1	1,2	1,5	1,6	2	2,5	2,6	3	3,2	3,6	4	5	6
127				4,714	5,024	6,260	7,794	8,099	9,315	9,920	11,124	12,320	15,274	18,179
129				4,789	5,104	6,360	7,919	8,229	9,465	10,080	11,304	12,520	15,525	18,480
133				4,939	5,264	6,560	8,169	8,490	9,766	10,401	11,665	12,921	16,026	19,080
139,7				5,191	5,533	6,896	8,589	8,926	10,269	10,937	12,269	13,592	16,864	20,087
153				5,690	6,066	7,562	9,421	9,792	11,268	12,003	13,468	14,924	18,530	22,085
154				5,728	6,106	7,612	9,484	9,857	11,343	12,083	13,558	15,024	18,655	22,236
155				5,765	6,146	7,662	9,547	9,922	11,418	12,163	13,648	15,124	18,780	22,386
156				5,803	6,186	7,712	9,609	9,987	11,493	12,244	13,738	15,224	18,905	22,536
159				5,916	6,306	7,863	9,797	10,182	11,719	12,484	14,008	15,525	19,281	22,987
168,3				6,265	6,679	8,328	10,379	10,788	12,417	13,229	14,847	16,456	20,445	24,384
204				7,606	8,109	10,116	12,614	13,112	15,099	16,090	18,065	20,032	24,915	29,748
205				7,643	8,149	10,166	12,677	13,177	15,174	16,170	18,155	20,132	25,040	29,898
206						10,216	12,739	13,242	15,249	16,250	18,245	20,232	25,165	30,048
219,1						10,872	13,559	14,095	16,233	17,300	19,426	21,544	26,805	32,016
254						12,620	15,744	16,367	18,855	20,096	22,572	25,040	31,175	37,260
255						12,670	15,807	16,432	18,930	20,176	22,662	25,140	31,300	37,410
256						12,720	15,869	16,497	19,005	20,256	22,752	25,240	31,425	37,560
273						13,572	16,933	17,604	20,282	21,619	24,285	26,943	33,554	40,114
304						15,124	18,874	19,622	22,611	24,103	27,079	30,048	37,435	44,772
306						15,224	18,999	19,753	22,761	24,263	27,260	30,248	37,685	45,072
323,9						16,121	20,120	20,918	24,106	25,697	28,873	32,041	39,926	47,761
355,6						17,708	22,104	22,982	26,487	28,237	31,731	35,216	43,895	52,524
406,4						20,252	25,284	26,289	30,303	32,308	36,310	40,304	50,255	60,156
508							31,644	32,904	37,936	40,449	45,469	50,481	62,976	75,420

Standard delivery program - Programma di fornitura standard

Round stainless steel welded tubes for heat resistances

Tubi tondi saldati in acciaio inossidabile per resistenze elettriche



ROUND TUBES EN 10217-7, EN 10296

Tubi tondi EN 10217-7, EN 10296

weight
kg/m

outside diameter mm	wall thickness mm					
	0,40	0,50	0,60	0,70	0,75	0,80
5	0,046	0,056	0,066	0,075	0,080	
6	0,056	0,069	0,081	0,093	0,099	
7,50	0,071	0,088	0,104	0,119	0,127	
8	0,076	0,094	0,111	0,128	0,136	0,144
9,50	0,091	0,113	0,134	0,154	0,164	0,174
10	0,096	0,119	0,141	0,163	0,174	0,184
12	0,116	0,144	0,171	0,198	0,211	0,224
12,7	0,123	0,153	0,182	0,210	0,224	0,238
13	0,126	0,157	0,186	0,216	0,230	0,244
14	0,136	0,169	0,201	0,233	0,249	0,264
15	0,146	0,182	0,216	0,251	0,268	0,284
16	0,156	0,194	0,231	0,268	0,286	0,304
17,2	0,168	0,209	0,249	0,289	0,309	0,329
18	0,176	0,219	0,261	0,303	0,324	0,345
19		0,232	0,276	0,321	0,343	0,365
19,05		0,232	0,277	0,322	0,344	0,366
20		0,244	0,291	0,338	0,362	0,385

Round stainless steel welded process pipes for oil and gas

Tubi tondi saldati in acciaio inossidabile per il settore petrolchimico

NPS		outside diameter mm	standard ANSI B 36-19					
			schedule 5S		schedule 10S		schedule 40S	
		wall thickness and weight						
		mm	kg/m	mm	kg/m	mm	kg/m	
3/8"	17,15			1,65	0,640	2,31	0,858	
1/2"	21,34	1,65	0,814	2,11	1,016	2,77	1,288	
3/4"	26,67	1,65	1,034	2,11	1,298	2,87	1,710	
1"	33,4	1,65	1,312	2,77	2,125	3,38	2,541	
1 1/4"	42,16	1,65	1,674	2,77	2,732	3,56	3,441	
1 1/2"	48,26	1,65	1,926	2,77	3,155	3,68	4,108	
2"	60,33	1,65	2,424	2,77	3,992	3,91	5,524	
2 1/2"	73,03	2,11	3,747	3,05	5,345	5,16	8,769	
3"	88,9	2,11	4,585	3,05	6,557	5,49	11,466	
3 1/2"	101,6	2,11	5,256	3,05	7,526	5,74	13,778	
4"	114,3	2,11	5,927	3,05	8,496	6,02	16,322	
6"	168,28	2,77	11,480	3,40	14,037	7,11	28,694	
8"	219,08	2,77	15,003	3,76	20,272	8,18	43,198	
10"	273,05	3,40	22,957	4,19	28,208			
12"	323,85	3,96	31,720	4,57	36,536			
14"	355,6	3,96	34,868	4,78	41,990			

Round stainless steel welded process tubes for heat exchangers/food and dairy industry

Tubi tondi saldati in acciaio inossidabile per scambiatori di calore e industria alimentare

outside diameter		Birmingham Wire Gauge				
		18	16	14	12	11
		wall thickness mm				
		1,24	1,65	2,11	2,77	3,05
mm	inches	weight kg/m				
15,88	5/8"	0,455	0,588	0,728		
19,05	3/4"	0,553	0,719	0,895		
25,4	1"	0,750	0,981	1,231	1,570	1,707
31,8	1 1/4"	0,949	1,246	1,569	2,014	2,196
38,1	1 1/2"	1,144	1,506	1,902	2,451	2,677
44,45	1 3/4"	1,342	1,768	2,237	2,891	3,162
50,8	2"	1,539	2,031	2,573	3,331	3,647
60,3	2 3/8"	1,834	2,423	3,074	3,990	4,372
63,5	2 1/2"	1,933	2,555	3,244	4,212	4,617
76,2	3"	2,327	3,080	3,915	5,093	5,587
88,9	3 1/2"		3,605	4,585	5,974	6,557
101,6	4"		4,130	5,256	6,855	7,526
114,3	4 1/2"		4,654	5,927	7,736	8,496

Round stainless steel welded process tubes for drinkable water and press fitting

Tubi tondi saldati in acciaio inossidabile per acque potabili e press fitting

outside diameter mm	wall thickness mm				weight kg/m
	1	1,2	1,5	2	
15	0,351				
18	0,426				
22		0,625			
28		0,805			
35			1,258		
42			1,521		
54			1,972		
76,1				3,711	
88,9				4,352	
108				5,308	



Round stainless steel welded process tubes for the food and dairy industry

Tubi tondi saldati in acciaio inossidabile per l'industria alimentare

outside diameter mm	wall thickness mm				weight kg/m
	1	1,5	1,6	2	
18	0,426	0,620			
19		0,657			
22	0,526	0,770			
23		0,808			
25	0,715				
28	0,676	0,995			
29		1,033			
33		1,183			
34	0,826	1,221			
35		1,258			
38	1,106	1,371	1,458		
40	0,977	1,446			
41		1,484			
43		1,559			
50,8	1,490	1,852	1,971		
51	1,496				
52	1,277	1,897			
53		1,934			
63,5		2,329	2,480		
70				3,405	
76,1		2,802	2,985		
85				4,157	
101,6				4,988	
104				5,108	
129				6,360	
154				7,612	
204				10,116	

Square stainless steel welded tubes

Tubi quadri saldati in acciaio inossidabile

external dimensions		wall thickness mm							weight kg/m	
		1	1,2	1,5	2	2,5	3	4		5
A x A mm										
10 x 10		0,294	0,347	0,422						
15 x 15		0,453	0,538	0,661	0,857					
16 x 16		0,485	0,576	0,709	0,921					
20 x 20		0,613	0,729	0,901	1,176					
25 x 25		0,772	0,921	1,140	1,495	1,837	2,167			
30 x 30		0,932	1,112	1,379	1,814	2,236	2,645			
35 x 35		1,091	1,304	1,618	2,133	2,635	3,124			
40 x 40		1,251	1,495	1,858	2,452	3,033	3,602	4,703		
45 x 45		1,410	1,686	2,097	2,771	3,432	4,081	5,341		
50 x 50			1,878	2,336	3,090	3,831	4,559	5,979	7,349	
60 x 60				2,814	3,728	4,628	5,516	7,255	8,943	
70 x 70				3,293	4,366	5,426	6,473	8,531	10,538	
80 x 80				3,771	5,004	6,223	7,430	9,807	12,133	
100 x 100				4,728	6,279	7,818	9,344	12,359	15,323	
120 x 120					7,555	9,413	11,258	14,910	18,513	
150 x 150					9,469	11,805	14,129	18,738	23,298	
200 x 200					12,659	15,793	18,913	25,118	31,272	
250 x 250							23,698	31,497	39,247	

Standard delivery program - Programma di fornitura standard

external dimensions		Birmingham Wire Gauge					weight kg/m
		18	16	14	11	7	
A mm	inches	wall thickness mm					
		1,24	1,65	2,11	3,05	4,57	
12,7	1/2"	0,464	0,600				
19,05	3/4"	0,715	0,934	1,171			
25,4	1"	0,966	1,269	1,598	2,238		
31,75	1 1/4"	1,217	1,603	2,025	2,856		
38,1	1 1/2"	1,468	1,937	2,453	3,474		
50,8	2"	1,971	2,606	3,308	4,709	6,882	
63,5	2 1/2"		3,274	4,162	5,945	8,734	
76,2	3"		3,942	5,017	7,181	10,585	
101,6	4"		5,279	6,727	9,652	14,288	

Rectangular stainless steel welded tubes

Tubi rettangolari saldati in acciaio inossidabile

external dimensions		wall thickness mm							weight kg/m	
		1	1,2	1,5	2	2,5	3	4		5
A x B mm										
20 x 10		0,453	0,538	0,661						
20 x 15		0,533	0,634	0,781	1,016					
25 x 10		0,533	0,634	0,781	1,016					
25 x 15		0,613	0,729	0,901	1,176					
30 x 10		0,613	0,729	0,901	1,176					
30 x 15		0,693	0,825	1,020	1,335					
30 x 20		0,772	0,921	1,140	1,495	1,837	2,167			
35 x 20		0,852	1,017	1,259	1,654	2,036	2,406			
40 x 10		0,772	0,921	1,140	1,495	1,837	2,167			
40 x 15		0,852	1,017	1,259	1,654	2,036	2,406			
40 x 20		0,932	1,112	1,379	1,814	2,236	2,645			
40 x 27		1,044	1,246	1,547	2,037	2,515	2,980			
40 x 30		1,091	1,304	1,618	2,133	2,635	3,124			
50 x 10		0,932	1,112	1,379	1,814	2,236	2,645			
50 x 20		1,091	1,304	1,618	2,133	2,635	3,124			
50 x 25		1,171	1,399	1,738	2,292	2,834	3,363			
50 x 30		1,251	1,495	1,858	2,452	3,033	3,602			
50 x 40		1,410	1,686	2,097	2,771	3,432	4,081			
60 x 10		1,091	1,304	1,618	2,133	2,635	3,124			
60 x 20		1,251	1,495	1,858	2,452	3,033	3,602			
60 x 30		1,410	1,686	2,097	2,771	3,432	4,081			
60 x 40				2,336	3,090	3,831	4,559	5,979		
70 x 20			2,097	2,771	3,432	4,081	5,341			
70 x 40			2,575	3,409	4,229	5,038	6,617			
80 x 20			2,336	3,090	3,831	4,559	5,979			
80 x 30			2,575	3,409	4,229	5,038	6,617			
80 x 40			2,814	3,728	4,628	5,516	7,255	8,943		
80 x 50			3,054	4,047	5,027	5,995	7,893	9,741		
80 x 60			3,293	4,366	5,426	6,473	8,531	10,538		
100 x 40			3,293	4,366	5,426	6,473	8,531	10,538		
100 x 50			3,532	4,685	5,824	6,952	9,169	11,336		
100 x 60			3,771	5,004	6,223	7,430	9,807	12,133		
100 x 80			4,250	5,641	7,021	8,387	11,083	13,728		
120 x 40			3,771	5,004	6,223	7,430	9,807	12,133		
120 x 60			4,250	5,641	7,021	8,387	11,083	13,728		
120 x 80			4,728	6,279	7,818	9,344	12,359	15,323		
150 x 50				6,279	7,818	9,344	12,359	15,323		
150 x 100				7,874	9,812	11,736	15,548	19,310		
160 x 80				7,555	9,413	11,258	14,910	18,513		
200 x 100				9,469	11,805	14,129	18,738	23,298		

Standard delivery program - Programma di fornitura standard

external dimensions A x B		Birmingham Wire Gauge					weight kg/m
		18	16	14	11	7	
		wall thickness mm					
mm	inch	1,24	1,65	2,11	3,05	4,57	
50,8 x 25,4	2" x 1"	1,468	1,937	2,453	3,474		
76,2 x 25,4	3" x 1"	1,969	2,603	3,304	4,704	6,875	
76,2 x 50,8	3" x 2"	2,473	3,274	4,162	5,945	8,734	
101,6 x 50,8	4" x 2"		3,942	5,017	7,181	10,585	

Oval stainless steel welded tubes

Tubi ovali saldati in acciaio inossidabile

external dimensions		wall thickness mm			
A x B mm		1	1,2	1,5	2
21,8 x 11,8		0,426	0,505	0,620	0,801
22 x 12		0,426	0,505	0,620	0,801
24 x 13		0,452	0,536	0,659	0,854
25,4 x 8		0,452	0,536	0,659	0,854
30 x 15		0,611	0,727	0,898	1,172
30 x 20		0,649	0,772	0,954	1,247
35 x 15		0,676	0,805	0,995	1,302
38,5 x 20		0,776	0,925	1,146	1,502
41 x 20		0,819	0,977	1,209	1,588
41,27 x 15,88		0,776	0,925	1,146	1,502
48,5 x 20		0,929	1,109	1,375	1,808
50 x 10		0,851	1,016	1,258	1,653



Special stainless steel shapes for window and door frames

Tubi di sagome speciali per serramenti in acciaio inossidabile

1A • 55%

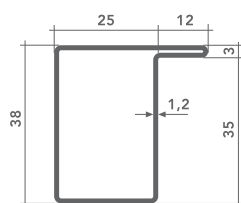

Thickness (mm)	kg/m
1,2	1,39

1B • 55%

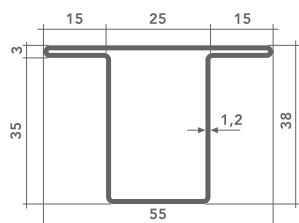

Thickness (mm)	kg/m
1,2	1,68

1C • 55%

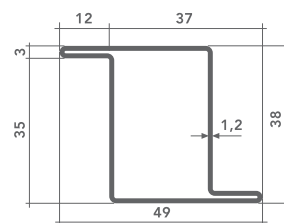

Thickness (mm)	kg/m
1,2	1,58



Standard delivery programs

Tabelle dimensionali del programma di fornitura standard

outside diameter mm	wall thickness mm				
	1	1,5	2	2,5	3
10	•	•			
12	○	•○			
15		•			
16	○	•○	•		
17,2			•		
18		•	•		
20		•○	•		
21,3			•		
25		•○	•		
26,9			•		
30		•○	•		
32		•	•		
33,7			•	•	
38		•○	•		
40		•○	•○		
42,4			•	•	•
48,3			•	•	
50		○	•		
50,8		○			
60,3			•	•	
76,1			•		
88,9			•		
114,3			•		
129			•		

• Polished - *Satinati* ○ Mirror polished - *Lucidati*



external dimensions A x B mm	wall thickness mm				
	1	1,2	1,5	2	3
15 x 15		•	•		
20 x 20		•	•	•	
25 x 25		•	•	•	
30 x 30		•	•	•	
35 x 35		•			
40 x 40	•	•	•	•	•
50 x 50			•	•	•
60 x 60				•	•
80 x 80				•	•
100 x 100					•

• Polished - *Satinati*

dimensions A x B mm	wall thickness mm			
	1,2	1,5	2	3
20 x 10		•		
25 x 10		•		
30 x 10	•	•		
30 x 15		•	•	
30 x 20		•	•	
40 x 10		•		
40 x 15		•		
40 x 20	•	•	•	
40 x 30			•	
50 x 10		•		
50 x 20		•	•	
50 x 25		•	•	
50 x 30		•	•	
60 x 20		•		
60 x 30		•	•	
60 x 40		•	•	•
80 x 40			•	•
100 x 40			•	
100 x 50			•	•
100 x 60				•
120 x 40			•	

• Polished - *Satinati*

Round stainless steel welded tubes for automotive applications

Tubi tondi saldati in acciaio inossidabile per applicazioni automotive

outside diameter mm	wall thickness mm										weight kg/m
	1		1,2		1,5		1,8		2		
	austenitic	ferritic	austenitic	ferritic	austenitic	ferritic	austenitic	ferritic	austenitic	ferritic	
20	0,476	0,471	0,565	0,559	0,695	0,688	0,820	0,812	0,901	0,893	
22	0,526	0,521	0,625	0,619	0,770	0,763	0,910	0,902	1,002	0,992	
25	0,601	0,595	0,715	0,708	0,883	0,874	1,046	1,036	1,152	1,141	
28	0,676	0,670	0,805	0,798	0,995	0,986	1,181	1,170	1,302	1,290	
30	0,726	0,719	0,865	0,857	1,070	1,060	1,271	1,259	1,402	1,389	
32	0,776	0,769	0,925	0,917	1,146	1,135	1,361	1,348	1,502	1,488	
35	0,851	0,843	1,016	1,006	1,258	1,246	1,496	1,482	1,653	1,637	
38	0,926	0,918	1,106	1,095	1,371	1,358	1,632	1,616	1,803	1,786	
40	0,977	0,967	1,166	1,155	1,446	1,432	1,722	1,705	1,903	1,885	
42	1,027	1,017	1,226	1,214	1,521	1,507	1,812	1,795	2,003	1,984	
45	1,102	1,091	1,316	1,303	1,634	1,618	1,947	1,928	2,153	2,133	
48	1,177	1,166	1,406	1,393	1,747	1,730	2,082	2,062	2,304	2,282	
50	1,227	1,215	1,466	1,452	1,822	1,804	2,172	2,152	2,404	2,381	
53	1,302	1,290	1,556	1,542	1,934	1,916	2,308	2,286	2,554	2,530	
54	1,327	1,314	1,587	1,571	1,972	1,953	2,353	2,330	2,604	2,579	
55	1,352	1,339	1,617	1,601	2,009	1,990	2,398	2,375	2,654	2,629	
57	1,402	1,389	1,677	1,661	2,085	2,065	2,488	2,464	2,754	2,728	
58	1,427	1,414	1,707	1,690	2,122	2,102	2,533	2,509	2,804	2,778	
60	1,477	1,463	1,767	1,750	2,197	2,176	2,623	2,598	2,905	2,877	
63,5	1,565	1,550	1,872	1,854	2,329	2,306	2,781	2,754	3,080	3,050	
65	1,603	1,587	1,917	1,899	2,385	2,362	2,849	2,821	3,155	3,125	
70			2,067	2,047	2,573	2,548	3,074	3,044	3,405	3,373	
76,1			2,251	2,229	2,802	2,775	3,349	3,317	3,711	3,675	
80			2,368	2,345	2,948	2,920	3,525	3,491	3,906	3,869	
84			2,488	2,464	3,099	3,069	3,705	3,669	4,107	4,067	
85			2,518	2,494	3,136	3,106	3,750	3,714	4,157	4,117	
88,9			2,635	2,610	3,283	3,251	3,926	3,888	4,352	4,310	
90					3,324	3,292	3,975	3,937	4,407	4,365	
95					3,512	3,478	4,201	4,160	4,657	4,613	
101,6					3,760	3,724	4,498	4,455	4,988	4,940	
104					3,850	3,813	4,606	4,562	5,108	5,059	
108					4,000	3,962	4,787	4,741	5,308	5,258	
110					4,075	4,036	4,877	4,830	5,409	5,357	
114,3					4,237	4,196	5,071	5,022	5,624	5,570	
120					4,451	4,408	5,328	5,276	5,909	5,853	
127					4,714	4,669	5,643	5,589	6,260	6,200	
129					4,789	4,743	5,733	5,678	6,360	6,299	
130					4,826	4,780	5,778	5,723	6,410	6,349	
139,7					5,191	5,141	6,215	6,156	6,896	6,830	
155					5,765	5,710	6,905	6,839	7,662	7,589	

Special stainless steel box sections

Tubi di sagome speciali in acciaio inossidabile

T. 1739

• 30%

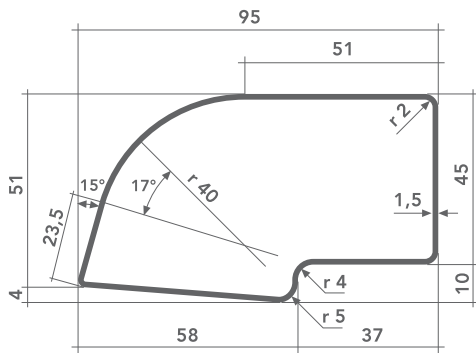

Thickness (mm)

kg/m

1,5

3,24

T. 2035

• 30%

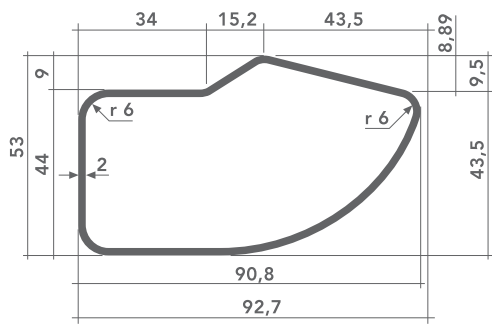

Thickness (mm)

kg/m

2

3,90

T. 2029

• 50%

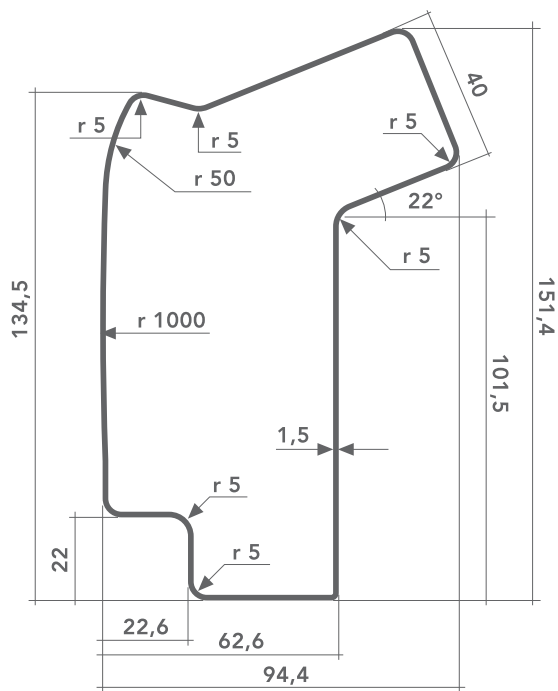

Thickness (mm)

kg/m

1,5

5,11

T. 1991

• 35%

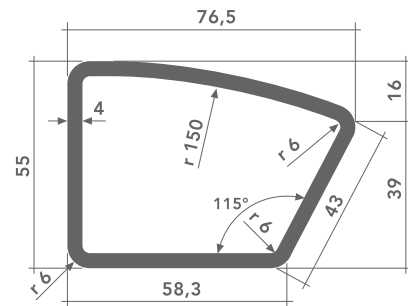

Thickness (mm)

kg/m

4

7,11

